

# High Visibility/traffic Retail

1912 Dover Rd, Epsom, NH 03234, USA

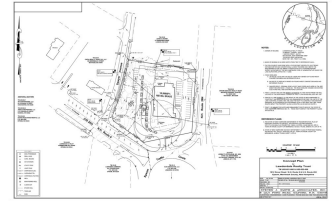

## Property Overview

Price/Rent PSF	Inquire
Asset Type	Retail
Trade Type	Lease
SQ. FT. Available	10,000
Date Available	11/12/2018
Additional URL	<a href="https://buildout.com/website/358310-lease">https://buildout.com/website/358310-lease</a>

## Contact



Dave Garvey  
Enterprise

✉ [davegarvey@kwcommercial.com](mailto:davegarvey@kwcommercial.com)

☎ 16034912854

🌐 <https://www.clcgkw.com/>

## Description

### Location

Amazing retail site, right on the Epsom Traffic Circle with visibility that you dream about. This to be built 10,000 square feet of retail will have a co-locator of an Aroma Joe's on the site. This building will have more than adequate parking and entry and exit on both ends of the lot. Located in an area with a substantial amount of commercial retail, including McDonalds, Dunkin Donuts, Subway, Banks etc., this is the crossroads of this area just east of Concord.

Lease  
NNN

## Location



